



IMPIAN PRISMA 3

DOUBLE STOREY SHOP OFFICE

YOUR PRIME BUSINESS OPPORTUNITY



Welcome to the 3rd Phase of Impian Prisma, where your business dreams find a home. These 2-storey shop-offices are not just another space, they are a gateway to your success.

With the success of our previous phases, Impian Prisma has earned a reputation for providing businesses with the ideal platform to flourish. This legacy of success carries on in Impian Prisma 3 and only 42 units are made available!



MARKET CATCHMENT AT ITS FINEST

Situated in the heart of Setia AlamImpian with 20,000 residential units and an approximate population of 80,000 people upon township completion, Impian Prisma 3 enjoys an enviable market catchment. Drawing from an affluent and diverse population in and around the vibrant township, your business will have the perfect audience to thrive!

ESTABLISHED TOWNSHIP WITH EXCELLENT INFRASTRUCTURE

Setia AlamImpian is beyond a vision, it's a thriving reality. With a community already in place, your business will be in the heart of an established, dynamic neighbourhood. We have also left no stone unturned in ensuring that our township boasts top-notch infrastructure. From well-maintained roads to modern amenities, everything you need for a seamless operation is at your doorstep.

TIP-TOP HIGHWAY CONNECTIVITY

With superb highway connections – KESAS, NKVE and Federal Highway, accessing your business location has never been easier. Impian Prisma 3's strategic location ensures that you are well-connected to major routes, facilitating accessibility for your customers.



MASTER SITE PLAN

FLOOR PLAN

TYPE C2
CORNER UNIT

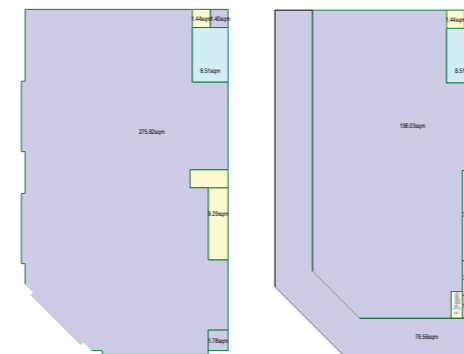

First Floor
3,210 sqft

Ground Floor
3,263 sqft

TYPE A2
INTERMEDIATE UNIT

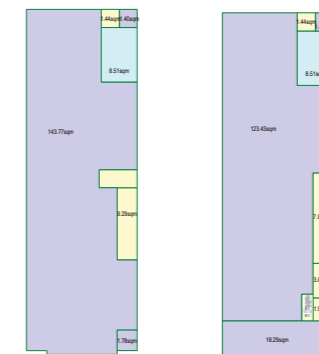

First Floor
1,789 sqft

Ground Floor
1,800sqft

TYPE B2
END UNIT



First Floor
2,057 sqft

Ground Floor
2,071 sqft

TYPE B1
INTERMEDIATE UNIT



First Floor
2,057 sqft

Ground Floor
2,071sqft

TYPE A1
INTERMEDIATE UNIT



First Floor
1,789 sqft

Ground Floor
1,800 sqft

TYPE C1
CORNER UNIT

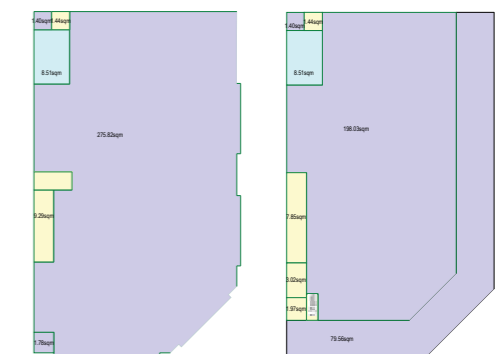

First Floor
3,210 sqft

Ground Floor
3,263sqft



Stay Together. Stay Setia
livelearnworkplay

Call +603 5162 7600

LakePoint Gallerie

1, Jalan Panglima Hitam 35/26, Alam Impian, Seksyen 35, 40470 Shah Alam, Selangor, Malaysia
T 603 5162 7600 F 603 5162 1478 E alamimpian@spsetia.com W www.spsetia.com/alam-impian

Setia