



INDAH PRIME III

2 STOREY COMMERCIAL SHOP OFFICE

TAMAN BUKIT INDAH

ELEVATE YOUR BUSINESS PRESENCE

Crafting space for your vision to grow.

60,000

RESIDENTIAL POPULATION WITHIN 4-5KM

200,000

PRIMARY CATCHMENT WITHIN 5-10 MIN DRIVE

5,000

OFFICE WORKERS WITHIN 2 KM



2 STOREY COMMERCIAL SHOP OFFICE

FLOOR PLAN & SPECIFICATION

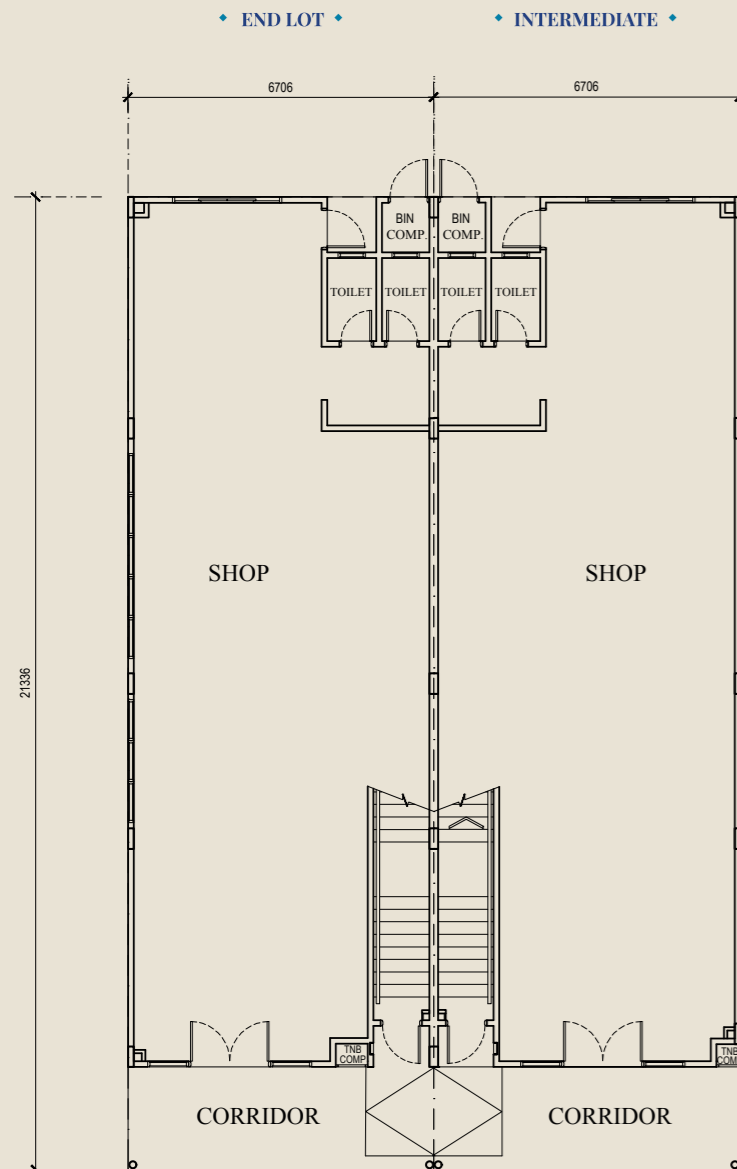

GROUND FLOOR

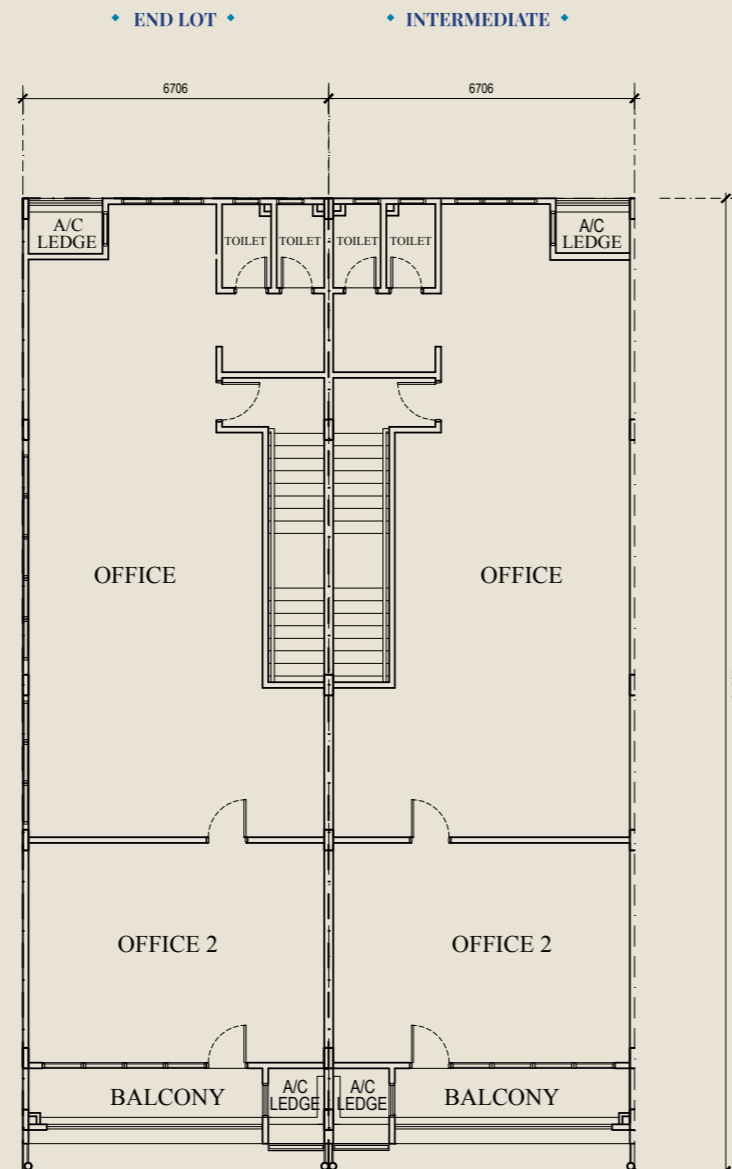

FIRST FLOOR

STRUCTURE	Reinforced concrete frame		
WALL	Brick wall / Light weight block		
ROOFING COVERING	Metal roofing sheet		
ROOF FRAMING	Lightweight truss		
CEILING	Skim coat, Cement board, Plaster ceiling board		
WINDOWS	Aluminium framed glass window		
DOORS	Glass door, Fire rated door, Plywood flush door, Mild steel door.		
IRONMONGERY	Quality lockset		
WALL FINISHES			
Toilet	2100mm height tiles		
Wash Hand Basin Area	1500mm height tiles		
FLOOR FINISHES			
Toilet, Corridor & Bin Compartment	Tiles		
Others	Cement Render		
SANITARY & PLUMBING FITTINGS	Quality sanitary wares with fittings		
ELECTRICAL INSTALLATIONS	Intermediate Lot	Special End/ End Lot	Special Corner/ Odd Corner/ Corner Lot
Light point	16 nos	17 nos	20 nos
Fan point	6 nos	6 nos	6 nos
13A Power Point	18 nos	18 nos	18 nos
INTERNAL TELECOMMUNICATION TRUNKING & CABLING	Intermediate Lot	Special End/ End Lot	Special Corner/ Odd Corner/ Corner Lot
Fiber wall socket	2 nos	2 nos	2 nos

BUILT UP **2,951**
SQUARE FEET
274.20m²

LAND SIZE **22 X 70**
22 FEET X 70 FEET
6.706m x 21.336m

Note : The Developer shall at its own cost and expense, install or construct all of the items listed above in accordance to the description set out save for the items or items marked with an * which may be deleted if not applicable.

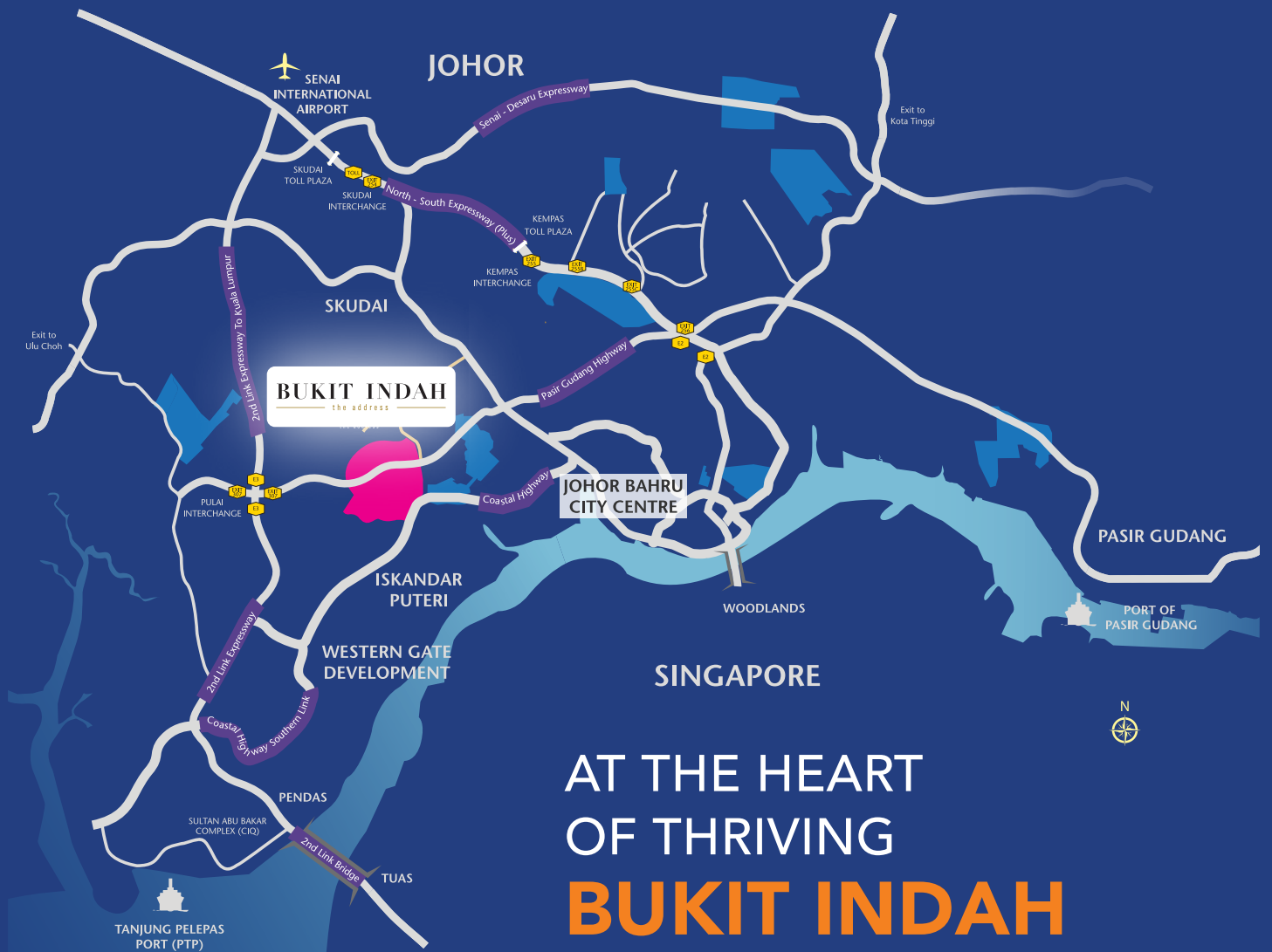

AT THE HEART OF THRIVING BUKIT INDAH

The vibrant and verdant Bukit Indah is where thriving residential and commercial zones combine for ample population catchment. Better still, a matured highway network offers easy access to amenities and commercial centres.



Stay Together. Stay Setia
livelearnworkplay

07 2775522

Bukit Indah (Johor) Sdn Bhd 199401021581 (307260-V)
Wisma S P Setia, S3-0111, Indahwalk 3, Jalan Indah 15,
Taman Bukit Indah, 79100 Iskandar Puteri, Johor Darul Takzim.
W bukitindahjohor.com
Mon. to Fri.: 9am - 6pm • Sat., Sun. & P.H.: 10am - 6pm

Setia