



Rimbun 3

DOUBLE STOREY TERRACE HOMES



Stay Together. Stay Setia
livelearnworkplay

Tel 603-8082 9525

BANDAR KINRARA WELCOME CENTRE

Eight Kinrara – Block B, Jalan BK5A/1, Bandar Kinrara, 47180 Puchong, Selangor Darul Ehsan.

T 603-8082 9525 **E** bandarkinrara@spsetia.com



I & P
Member of

Setia

Modern Residences within a Serene Neighbourhood

Tropical homes set in the serene, matured township of Bandar Kindara, Puchong. Welcome home to Rimbun 3, seamlessly integrating the lush outdoors with thoughtfully crafted wide spaces inside. We offers an oasis of comfort for you to come home to, every day.

Matured
Neighbourhood

FREEHOLD

Strategic
Location

Easy
Accessibility







Everything within Reach

Bask in the sunlight as it illuminates your home while preparing for a new day ahead. Breathe in the fresh morning air as you open your windows, and let your gaze fall upon the terraces and greenery. Enjoy the tranquillity and peace at Rimbun 3.



Site Plan

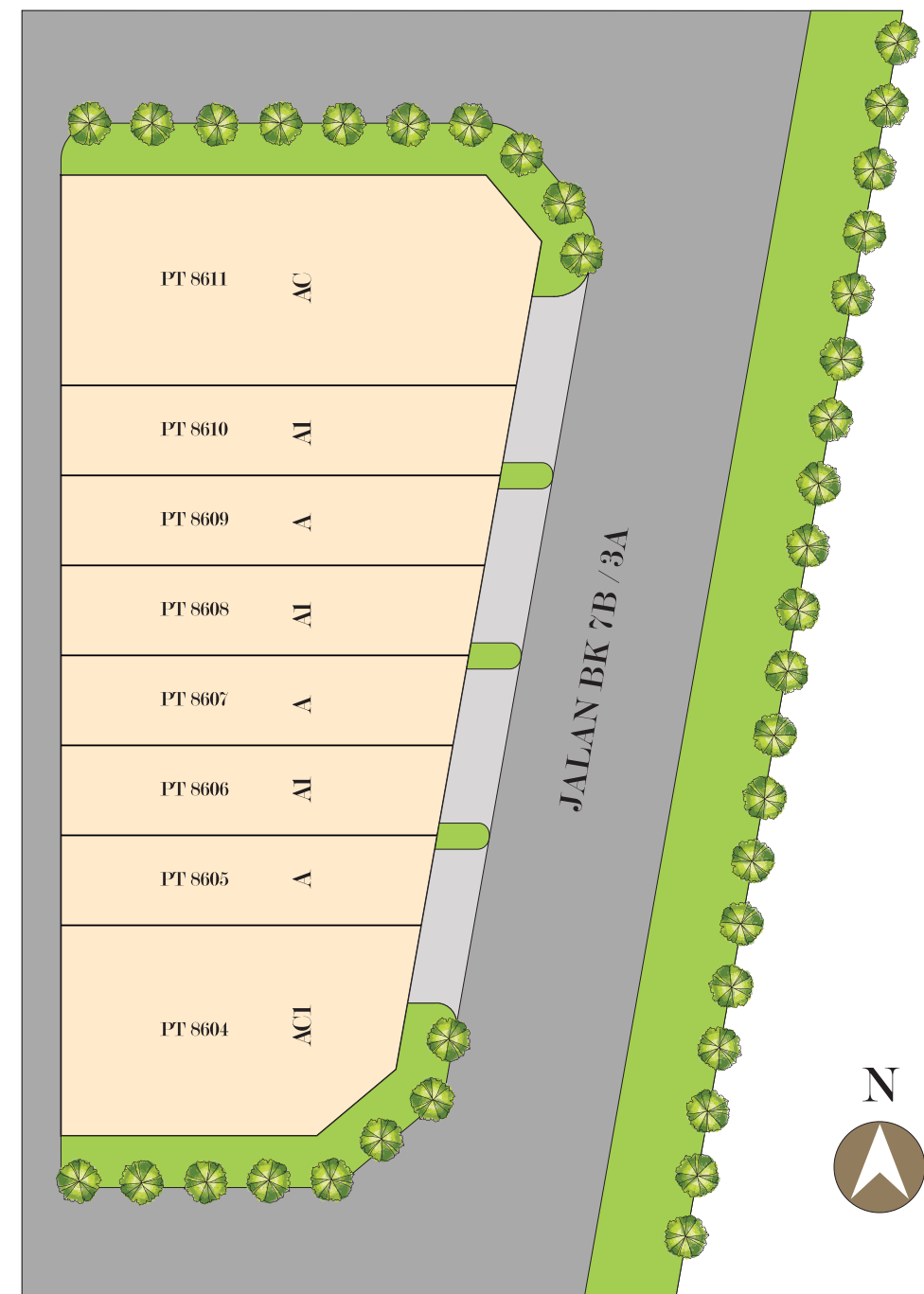



Ground Floor

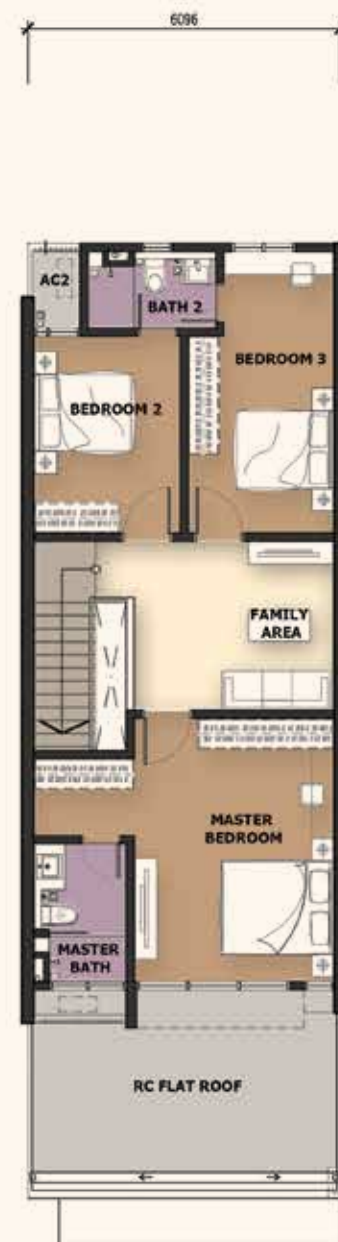

First Floor



Ground Floor



First Floor

TYPE A (Intermediate Unit)

Built-up Area : 2,230 sq.ft.
Land Area : 1,638 sq.ft. – 1,920 sq.ft.

TYPE AC1 (Corner Unit)

Built-up Area : 2,658 sq.ft.
Land Area : 3,488 sq.ft.

SPECIFICATION

a) Structure		: Reinforced Concrete			
b) Walls		: Cement Sand Bricks / Clay Brick (Party Wall)			
c) Roof Covering		: Concrete Roof Tiles			
d) Roof Framing		: Light Weight Steel Trusses			
e) Ceiling		: Plaster Ceiling			
		: Plaster and Paint / Skim Coat			
f) Windows	: All Areas	: Aluminium Framed Casement			
		: Aluminium Framed Fixed Glass			
		: Aluminium Framed Sliding			
		: Aluminium Framed Top Hung			
g) Doors	: Main Entrance	: Timber Door			
	: Living	: Aluminium Frame Sliding Door			
	: Master Bedroom / Bedroom 2 / Bedroom 3	: Timber Door			
	: Bathrooms	: Timber Door			
	: Kitchen	: Timber Door			
	: Store	: Timber Louvered Door			
	: Bedroom 1	: Timber Door			
	: Yard	: M.S. Grill Door			
h) Ironmongery		: Provided			
i) Wall Finishes	: Internal Walls	: Plaster And Paint			
	: External Walls	: Plaster And Paint			
	: Kitchen	: 5' Height Tiles			
	: Bathrooms	: Ceiling Height Tiles			
j) Floor Finishes	: Car Porch	: Tiles			
	: Driveway	: Concrete Broom Finish			
	: Living	: Tiles			
	: Dining	: Tiles			
	: Bedroom 1	: Tiles			
	: Store	: Cement Screed			
	: Master Bedroom / Bedroom 2 / Bedroom 3	: Timber Flooring			
	: Family Hall	: Timber Flooring			
	: Staircase	: Timber Flooring			
	: Bathrooms	: Tiles			
	: Kitchen	: Tiles			
	Yard	Tiles			
	Terrace	Tiles			
k) Sanitary & Plumbing Fittings	TYPE	A / A1		AC / AC1	
	: Water Closet	3		3	
	: Wash Basin	3		3	
	: Shower	3		3	
	: Paper Roll Holder	3		3	
	: Hand Bidet	3		3	
	: Kitchen Sink	1		1	
l) Electrical Installation	TYPE	A/A1		AC/AC1	
	: Light Point	27		28	
	: Power Point	22		22	
	: Air-conditioner Electrical Point	4		4	
	: Water Heater Electrical Point	3		3	
	: Fan Point	7		7	
	: TV Point	3		3	
	: Bell Point	1		1	
	: Autogate Point	1		1	
	: Booster Pump	Provided		Provided	
m) Internal Telecommunication Trunking and Cabling		Provided			
n) Fencing		Provided			
o) Turfing		Not Provided			
p) Gas Piping		Not Provided			

LOCATION MAP

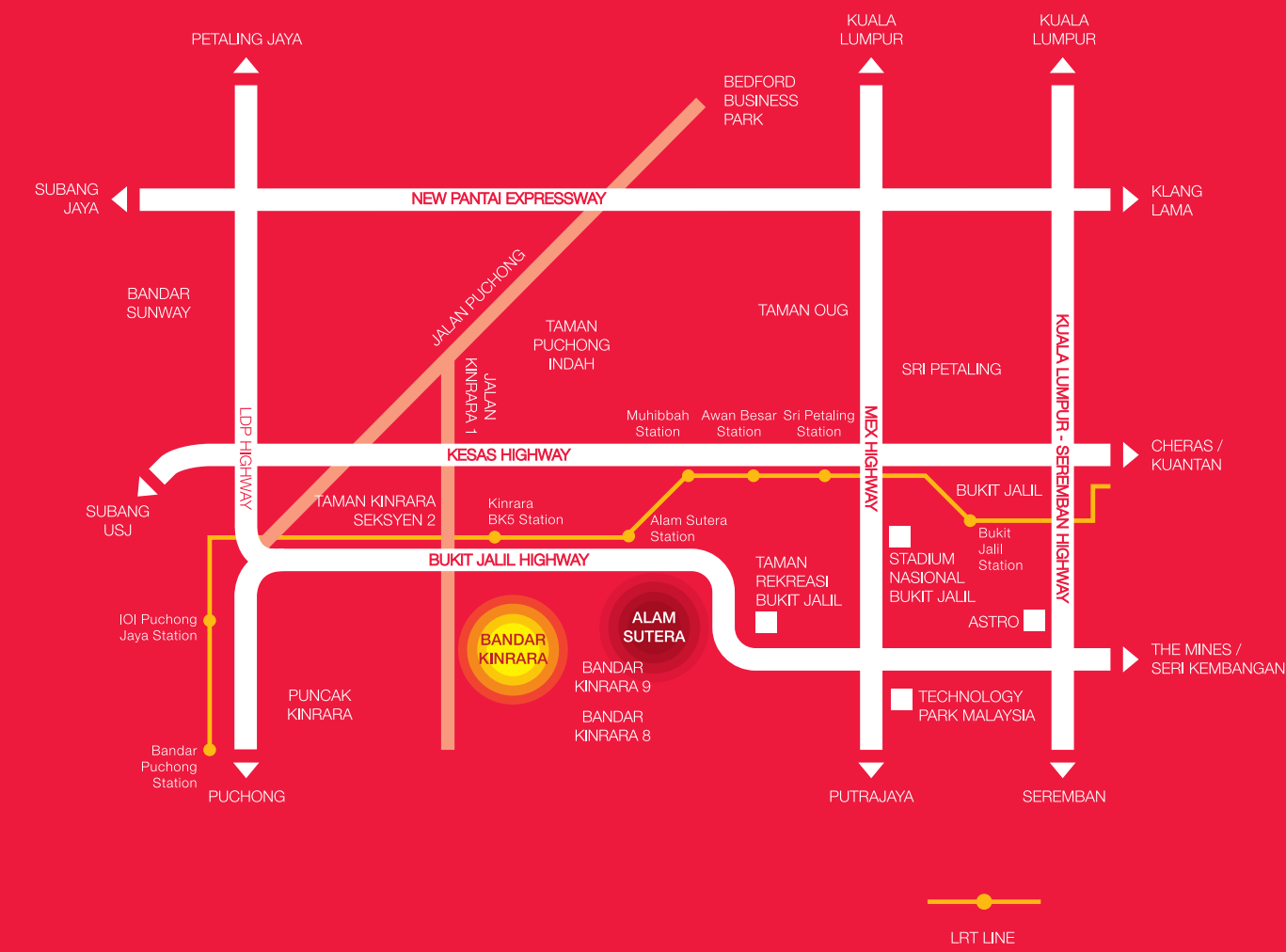

Bandar Kinrara (Double Storey Terrace) • Developer: Perumahan Kinrara Berhad (305-P) (a member of Setia) • Developer Address: Bandar Kinrara Welcome Centre, Eight Kinrara – Block B, Jalan BK 5A/1, Bandar Kinrara, 47180 Puchong, Selangor Darul Ehsan Tel: 03-80829600 • Developer’s License No: 4924-70/07-2022/0435 (L) • Validity Period: 25/07/2020 to 24/07/2022 • Advertising and Sales Permit No: 4924-70/07-2022/0435 (P) • Validity Period: 25/07/2020 to 24/07/2022 • Approving Authority: Majlis Perbandaran Subang Jaya • Building Plan Approval No: MPSJ.BGN.BP4.600-1/10/4/14 (18) • Expected Date of Completion: August 2022 • Restriction in interest (if any): Nil • Land Encumbrance (if any): Nil • Tenure of Land: Freehold • No. of Units: 8 • Selling Price: Min RM983,000 - Max RM1,350,000 • Discount: 7% for Bumiputra