

Position Yourself For Outstanding Business Success



Indah Prime II

2 STOREY SHOP OFFICES

- Spacious flexi business space
- Excellent access & highly visible from main road
- Modern contemporary facade design
- With double-volume ceiling to maximise space



Artist's Impression



AT THE HEART OF THRIVING BUKIT INDAH

The vibrant and verdant Bukit Indah is where thriving residential and commercial zones combine for ample population catchment. Better still, a matured highway network offers easy access to amenities and commercial centres.



Indah Prime II

2 STOREY SHOP OFFICES

BUKIT INDAH
the address

Stay Together. Stay Setia
livelearnworkplay



Scan to chat with us

+607 241 2255
Bukit Indah (Johor) Sdn Bhd 199401021581 (307260-V)
Wisma S P Setia, S3-0111, Indahwalk 3, Jalan Indah 15,
Taman Bukit Indah, 81200 Johor Bahru, Johor.
F +607 241 5955 W bukitindahjohor.com
Mon. to Fri.: 9am - 6pm • Sat., Sun. & P.H.: 10am - 6pm

Setia

The information contained herein is subject to change without notification as may be required by the authorities or developer's consultants and is not intended to form and cannot form part of an offer or contract.



Designed For Various Types Of Businesses

Artist's Impression



Indah Prime 2's double-volume ceiling gives you adequate space for any business and the flexibility to convert it into a mezzanine floor for an attractive business premise.

- F&B, fine dining restaurants, cafes
- Wellness & beauty centres
- Lifestyle fashion & accessories
- Retail & services
- Themed bookstores & stationery
- IT gadgets & electronics
- Gaming centre
- Designer furniture
- Arts & craft centre, and more



Site Plan

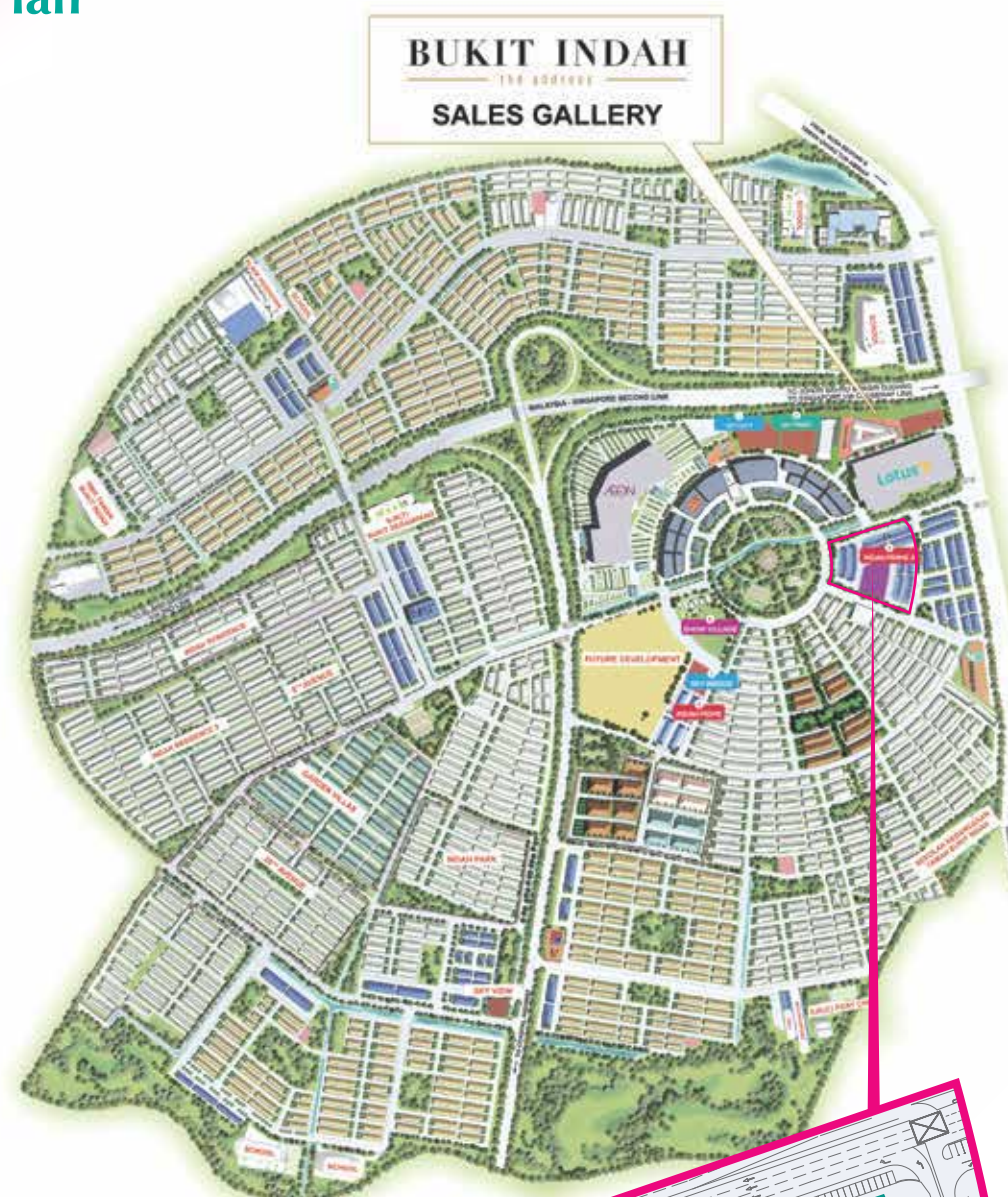

Legend

- 22' x 70'
 - 24' x 70'
 - BUMI LOT
- N

Floor Plan

22' x 70' | Intermediate Lot

Built-up from 3,072 sq.ft.

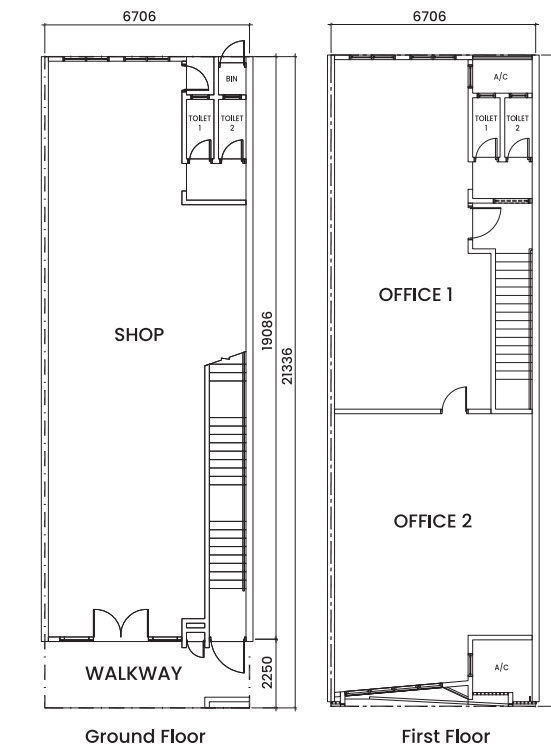

24' x 70' | Intermediate Lot

Built-up from 3,352 sq.ft.

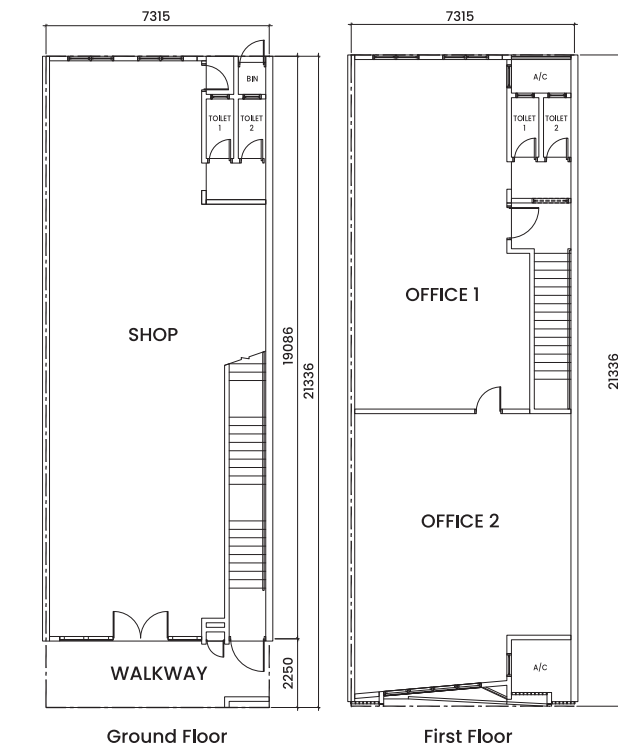

Specifications

Structure	: Reinforced concrete framework	Sanitary & Plumbing Fittings	: Quality sanitary wares with fittings
Wall	: Brickwall, light weight block	Electrical Installations	: Int./Special Int./ Corner/ End/Odd end lot Odd corner lot
Roof Covering	: Metal roofing	Lighting Points	: 21 nos. 31 nos.
Roof Framing	: Light weight truss, purlin	Power Point (13A)	: 16 nos. 16 nos.
Ceiling	: Plaster ceiling board, skim coat	Fan Point	: 6 nos. 6 nos.
Windows	: Aluminium frame window	Internal Telecommunication Trunking & Cabling	: 2 nos. 2 nos.
Doors	: Glass door, fire rated door, flush door	Fiber Wall Socket	: 2 nos. 2 nos.
Ironmongery	: Quality lockset		
Wall Finishes	: All toilets - 1500mm height tiles Basin area - 1500mm height tiles		
Floor Finishes	: All toilets & walkway - tiles Others - Cement render		

Note: The Developer shall, at its own cost and expense, install or construct all of the items listed above in accordance with the description set out save for the item or items marked with an * which may be deleted if not applicable.